

## PRODUCT DATA SHEET

Standing: 2024-11-15

### LAUDA Bath B 4

4 l, insulated, with drain

Part Number: LCZ 0707

#### Features

- Bath vessel made from stainless steel with drain valve
- The outer jacket is made of insensitive, powder-coated sheet steel.
- Four black device feet screwed to the bottom of the case. Height: 15 cm

#### Technical Features

Overall dimensions (WxDxH)	168 x 271 x 196 mm
Usable floor space width	75 mm
Usable floor space depth	178 mm
Material	Stainless steel
Bath opening max. width	135 mm
Bath opening max. depth	240 mm
Bath depth	150 mm
Usable depth	130 mm

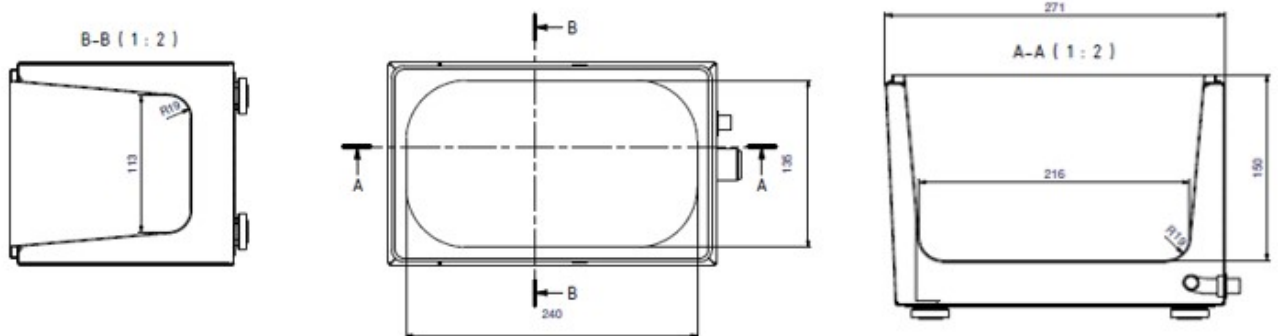

LAUDA DR. R. WOBSEY GMBH & CO. KG  
Laudaplatz 1 • 97922 Lauda-Königshofen • DE

T + 49 (0) 9343 503-0  
info@lauda.de • www.lauda.de  
WEEE-Reg-Nr.: DE 66 42 40 57

Kommanditgesellschaft: Sitz Lauda-Königshofen  
Registergericht Mannheim • HRA 560069

Persönlich haftende Gesellschafterin:  
LAUDA DR. R. WOBSEY Verwaltungs-GmbH  
Sitz Lauda-Königshofen  
Registergericht Mannheim • HRB 560226

Geschäftsführer:  
Dr. Gunther Wobser (Vors.), Dr. Mario Englert,  
Dr. Marc Stricker  
Beirat: Dr. Gerhard Wobser